

Whilst every attempt has been made to ensure the accuracy of the floor plan contained here, measurements of doors, windows, rooms and any other items are approximate and no responsibility is taken for any error, omission, or mis-statement. This plan is for illustrative purposes only and should be used as such by any prospective purchaser. The services, systems and appliances shown have not been tested and no guarantee as to their operability or efficiency can be given.
 Made with Metropix ©2021

GROUND FLOOR
 APPROX. FLOOR AREA 34.1 SQ.M. (367 SQ.FT.)
 1ST FLOOR
 APPROX. FLOOR AREA 34.1 SQ.M. (367 SQ.FT.)
 TOTAL APPROX. FLOOR AREA 68.2 SQ.M. (734 SQ.FT.)

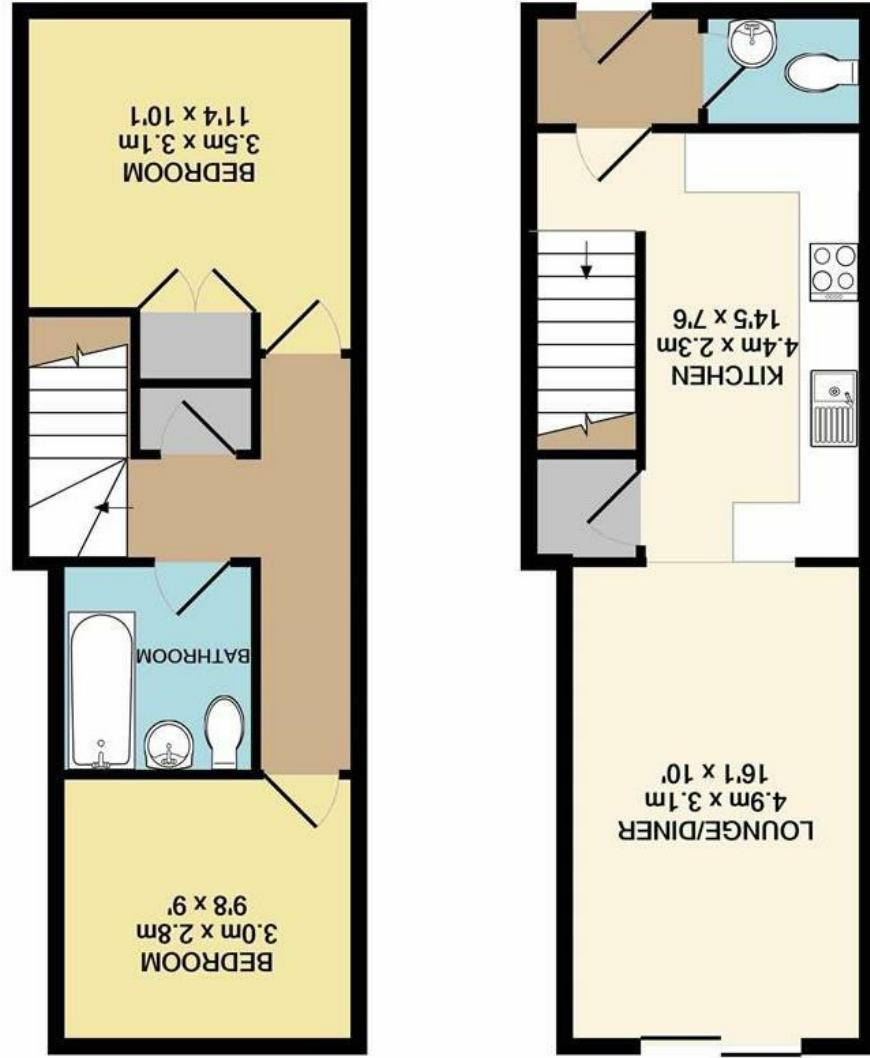

Disclaimer – In accordance with the Property Misdescriptions Act, the company gives notice that all descriptions, references to condition, necessary permissions for use and other details are given in good faith and believed to be correct, but any intending lessees do not rely on them as statements of fact, but must satisfy themselves by inspection or other means, as to their accuracy.

England & Wales	
EU Directive 2002/91/EC	
Very energy efficient - lower running costs	(92 plus) A
	(81-91) B
	(69-80) C
	(55-68) D
	(39-54) E
	(21-38) F
Not energy efficient - higher running costs	(1-20) G
Current	Potential

Energy Efficiency Rating



Abbs Close | Norwich | NR10
 Guide Price £235,000





abbotFox Land & New Homes presents this impressive two bedroom semi detached house in the much sought after market town of Reepham.

Accommodation comprises; entrance hall, WC, open plan kitchen living room, two bedrooms and bathroom off landing.

Reepham is a popular market town with a good range of amenities and exceptional schooling. The Dial House, a highly regarded restaurant and sister of Norwich based restaurant Farmyard is within walking distance.

